

NOTICE!!

These documents have been scanned!

Do not place un-scanned documents beneath this notice!

Do not remove this notice from this file!

GPO Jacket No. 560-102
Print Order 61540
Rise Business Services, LLC
Job=AZ15 5/14/2019



Box Number= AZ15047



Claim Begin-End: AMC415645-AMC415645

1 Initial Receipt



AZ15047-5

AMC415557-AMC416189

United States Department of the Interior
Bureau of Land Management
 LANDS/RECREATION & PLANNING
 ONE N CENTRAL AVE
 PHOENIX, AZ 85004 -2203
 Phone: 602-417-9200

Receipt

No: 2565345

Transaction #: 2644589	ENTERED INTO COMPUTER
Date of Transaction: 05/08/2012	
CUSTOMER:	
DON WOTHERSPOON 2310 SWIFT DR LAKE HAVASU CITY, AZ 86404-2037 US	

MAY 16 2012 *DB*

LINE #	QTY	DESCRIPTION	REMARKS	UNIT PRICE	TOTAL
1	1.00	LOCATABLE MINERALS / MINING CLAIMS- NEW, UNADJUD, ONE OR MORE AUTH NOS / NEW MINING CLAIM LOCATION FEE \$34 CASES: AMC415645/\$34.00		- n/a -	34.00
2	1.00	LOCATABLE MINERALS / MINING CLAIMS- NEW, UNADJUD, ONE OR MORE AUTH NOS / NEW MINING CLAIM MAINT FEE \$140 CASES: AMC415645/\$140.00		- n/a -	140.00
3	1.00	LOCATABLE MINERALS / MINING CLAIMS- NEW, UNADJUD, ONE OR MORE AUTH NOS / NEW MINING CLAIM PROCESSING FEE \$15 CASES: AMC415645/\$15.00		- n/a -	15.00
TOTAL:					\$189.00

PAYMENT INFORMATION				
1	AMOUNT:	189.00	POSTMARKED:	05/01/2012
	TYPE:	CHECK	RECEIVED:	05/07/2012
	CHECK NO:	701		
	NAME:	WOTHERSPOON, DON 2310 SWIFT DR LAKE HAVASU CITY AZ 86404-2037 US		

REMARKS

This receipt was generated by the automated BLM Collections and Billing System and is a paper representation of a portion of the official electronic record contained therein.

NOTICE!!

These documents have been scanned!

Do not place un-scanned documents beneath this notice!

Do not remove this notice from this file!

GPO Jacket No. 560-102
Print Order 61540
Rise Business Services, LLC
Job=AZ15 5/14/2019



Box Number= AZ15047



Claim Begin-End: AMC415645-AMC415645

2 Correspondence



AZ15047-5

AMC415557-AMC416189

**NO
DOCUMENTS
FOUND**

NO DOCUMENTS FOUND
NO DOCUMENTS FOUND

NOTICE!!

These documents have been scanned!

Do not place un-scanned documents beneath this notice!

Do not remove this notice from this file!

GPO Jacket No. 560-102
Print Order 61540
Rise Business Services, LLC
Job=AZ15 5/14/2019



Box Number= AZ15047



Claim Begin-End: AMC415645-AMC415645

3 Transfers



AZ15047-5

AMC415557-AMC416189

**NO
DOCUMENTS
FOUND**

NO DOCUMENTS FOUND
NO DOCUMENTS FOUND

NOTICE!!

These documents have been scanned!

Do not place un-scanned documents beneath this notice!

Do not remove this notice from this file!

GPO Jacket No. 560-102
Print Order 61540
Rise Business Services, LLC
Job=AZ15 5/14/2019



Box Number= AZ15047



Claim Begin-End: AMC415645-AMC415645

4 Miscellaneous



AZ15047-5

AMC415557-AMC416189

**NO
DOCUMENTS
FOUND**

NO DOCUMENTS FOUND
NO DOCUMENTS FOUND

NOTICE!!

These documents have been scanned!

Do not place un-scanned documents beneath this notice!

Do not remove this notice from this file!

GPO Jacket No. 560-102
Print Order 61540
Rise Business Services, LLC
Job=AZ15 5/14/2019



Box Number= AZ15047



Claim Begin-End: AMC415645-AMC415645

5 Annual Filings



AZ15047-5

AMC415557-AMC416189

Run Date: 08/07/18

Run Time: 04:41 PM

**DEPARTMENT OF THE INTERIOR
BUREAU OF LAND MANAGEMENT
MINING CLAIMS**

MC Maintenance Fees Paid Through the BLM Pay Portal

CBS Receipt: 4227183

Printed For Lead File # **AMC415645**

Agency Tracking ID: 1533326834

Assessment Year: 2019

Number of BLM Serial Nr: 3

Paid On: 08/03/2018

Total Amount Paid: \$465.00

Claim Name	BLM Serial No	Lead File No	Amount Paid
MIDNIGHT	AMC413956	AMC413935	\$155.00
RIOS ORO 2	AMC415645	AMC415645	\$155.00
GOLD HAWK	AMC432620	AMC432620	\$155.00

United States Department of the Interior

Bureau of Land Management
 BUSINESS & SUPPORT SVCS DIV
 ONE N CENTRAL AVE SUITE 800
 PHOENIX, AZ 85004 -4427
 Phone: 602-417-9200

Receipt

No: 4227183

Transaction #: 4342439	
Date of Transaction: 08/03/2018	
CUSTOMER:	
DONALD L WOTHERSPOON 2310 SWIFT DR LAKE HAVASU CITY,AZ 864042037 US	

LINE #	QTY	DESCRIPTION	REMARKS	UNIT PRICE	TOTAL
1	1.00	LOCATABLE MINERALS / MINING CLAIMS- NOT NEW-UNADJUD,ONE AUTH NO. ONLY / MINING CLAIM MONEY RECEIVED CASES: AMC413956/\$465.00		- n/a -	465.00
TOTAL:					\$465.00

PAYMENT INFORMATION			
NOTE: Items will appear on credit card statement as "BLM O Mining Claim".			
1	AMOUNT:	465.00	POSTMARKED: N/A
	TYPE:	CREDIT CARD	RECEIVED: 08/03/2018
	NAME:	DONALD L WOTHERSPOON 2310 SWIFT DR LAKE HAVASU CITY AZ 864042037 US	
	CARD NO:	XXXXXXXXXXXX1099	AUTH CODE: 009133
	NAME ON CARD:	DONALD L WOTHERSPOON	
	SIGNATURE:		

REMARKS

This receipt was generated by the automated BLM Collections and Billing System and is a paper representation of a portion of the official electronic record contained therein.

Run Date: 07/31/17

Run Time: 02:19 PM

**DEPARTMENT OF THE INTERIOR
BUREAU OF LAND MANAGEMENT
MINING CLAIMS**

MC Maintenance Fees Paid Through the BLM Pay Portal

CBS Receipt: 3898148

Printed For Lead File # AMC415645

Agency Tracking ID: 1500567208

Assessment Year: 2018

Number of BLM Serial Nr: 3

Paid On: 07/20/2017

Total Amount Paid: \$465.00

Claim Name	BLM Serial No	Lead File No	Amount Paid
MIDNIGHT	AMC413956	AMC413935	\$155.00
RIOS ORO 2	AMC415645	AMC415645	\$155.00
GOLD HAWK	AMC432620	AMC432620	\$155.00

United States Department of the Interior
Bureau of Land Management
 BUSINESS & SUPPORT SVCS DIV
 ONE N CENTRAL AVE SUITE 800
 PHOENIX, AZ 85004 -4427
 Phone: 602-417-9200

Receipt

No: 3898148

Transaction #: 4007462	
Date of Transaction: 07/20/2017	
CUSTOMER:	
DONALD L WOTHERSPOON 2310 SWIFT DR LAKE HAVASU CITY,AZ 86404 US	

LINE #	QTY	DESCRIPTION	REMARKS	UNIT PRICE	TOTAL
1	1.00	LOCATABLE MINERALS / MINING CLAIMS- NOT NEW-UNADJUD,ONE AUTH NO. ONLY / MINING CLAIM MONEY RECEIVED CASES: AMC415645/\$465.00		- n/a -	465.00
TOTAL:					\$465.00

PAYMENT INFORMATION			
NOTE: Items will appear on credit card statement as "BLM O Mining Claim".			
1	AMOUNT:	465.00	POSTMARKED: N/A
	TYPE:	CREDIT CARD	RECEIVED: 07/20/2017
	NAME:	DONALD L WOTHERSPOON 2310 SWIFT DR LAKE HAVASU CITY AZ 86404 US	
	CARD NO:	XXXXXXXXXXXX1905	AUTH CODE: 736757
	NAME ON CARD:	DONALD L WOTHERSPOON	
	EXPIRES:	05/2019	
	SIGNATURE:		

REMARKS

This receipt was generated by the automated BLM Collections and Billing System and is a paper representation of a portion of the official electronic record contained therein.

Run Date: 08/01/16

Run Time: 09:50 AM

**DEPARTMENT OF THE INTERIOR
BUREAU OF LAND MANAGEMENT
MINING CLAIMS**

MC Maintenance Fees Paid Through the BLM Pay Portal

CBS Receipt: 3602926

Printed For Lead File # AMC415645

Agency Tracking ID: 1468000733

Assessment Year: 2017

Number of BLM Serial Nr: 1

Paid On: 07/08/2016

Total Amount Paid: \$155.00

Claim Name	BLM Serial No	Lead File No	Amount Paid
RIOS ORO 2	AMC415645	AMC415645	\$155.00

United States Department of the Interior
Bureau of Land Management
 BUSINESS & SUPPORT SVCS DIV
 ONE N CENTRAL AVE SUITE 800
 PHOENIX, AZ 85004 -4427
 Phone: (602) 417-9200

Receipt

No: 3602926

Transaction #: 3706305	
Date of Transaction: 07/08/2016	
CUSTOMER:	
DONALD L WOTHERSPOON 2310 SWIFT DR LAKE HAVASU CITY,AZ 864042037 US	

LINE #	QTY	DESCRIPTION	REMARKS	UNIT PRICE	TOTAL
1	1.00	LOCATABLE MINERALS / MINING CLAIMS- NOT NEW-UNADJUD,ONE AUTH NO. ONLY / MINING CLAIM MONEY RECEIVED CASES: AMC415645/\$155.00		- n/a -	155.00
TOTAL:					\$155.00

PAYMENT INFORMATION					
NOTE: Items will appear on credit card statement as "BLM O Mining Claim".					
1	AMOUNT:	155.00	POSTMARKED:	N/A	
	TYPE:	CREDIT CARD	RECEIVED:	07/08/2016	
	NAME:	DONALD L WOTHERSPOON 2310 SWIFT DR LAKE HAVASU CITY AZ 864042037 US			
	CARD NO:	XXXXXXXXXXXX1905	AUTH CODE:	449931	
	NAME ON CARD:	DONALD L WOTHERSPOON			
	EXPIRES:	05/2019			
	SIGNATURE:				

REMARKS

This receipt was generated by the automated BLM Collections and Billing System and is a paper representation of a portion of the official electronic record contained therein.

AMC 415645

UNITED STATES
DEPARTMENT OF THE INTERIOR
BUREAU OF LAND MANAGEMENT
**MAINTENANCE FEE PAYMENT FORM FOR
LODE CLAIMS, MILL SITES, AND TUNNEL SITES**

Remitter Name: DON WOTHERSPOON
Mailing Address: 2310 SWIFT DR.
City, State, Zip: LAKE HAVASU CITY, AZ 86404

Check here if this is a change of address.

FOR COUNTY RECORDER'S USE

No. of claims/sites 1
x \$140 per claim/site
Total due BLM \$ 155⁰⁰

- The maintenance fee may be paid by cash, check, money order, Bureau of Land Management (BLM) Declining Deposit Account, or credit card (VISA, American Express, Discover, or MasterCard). Payments must be remitted to the BLM State Office where your claim or site is recorded and received on or before September 1. If the payment is mailed, the envelope must be postmarked by a bona fide delivery service on or before September 1 and received at the proper BLM State Office within 15 calendar days after the due date. Payments may also be made by telephone using a credit card. A complete listing of BLM State Offices with their addresses and phone numbers can be found at <http://www.blm.gov>.
- The maintenance fee for the following claim(s)/site(s) applies to the assessment year 2015.

CLAIM/SITE NAME	BLM SERIAL NO.
Rios ORO Z	AMC 415645

RECEIVED
BLM / STATE OFFICE
2014 JUL -9 P 3:05
PHOENIX, ARIZONA

Use a separate sheet for additional claim/site names, serial numbers, and claimant names and addresses.

(Continued on page 2)

INTERESTED
JUL 15 2014
BY: RAM

3074395



Donald Wotherspoon

2310 Swift Dr.
Lk Havasu City, AZ 86404-2037

LAS VEGAS NV 890

07 JUL 2014 PM 5 L



RECEIVED
BLM AZ STATE OFFICE

2014 JUL -9 P 2:59

PHOENIX, ARIZONA

BLM AZ State Office
One North Central ave
Suite 800

Phoenix, AZ. 85004-4427

85004442700



Maintenance
Payment

United States Department of the Interior
Bureau of Land Management
 LANDS/RECREATION & PLANNING
 ONE N CENTRAL AVE
 PHOENIX, AZ 85004 -2203
 Phone: 602-417-9200

Receipt

No: 3074395

Transaction #: 3165571	
Date of Transaction: 07/10/2014	
CUSTOMER:	
DON WOTHERSPOON 2310 SWIFT DR LAKE HAVASU CITY,AZ 86404-2037 US	

LINE #	QTY	DESCRIPTION	REMARKS	UNIT PRICE	TOTAL
1	1.00	LOCATABLE MINERALS / MINING CLAIMS- NOT NEW-UNADJUD,ONE AUTH NO. ONLY / MINING CLAIM MONEY RECEIVED CASES: AMC415645/\$155.00	MAINT 2015/1	- n/a -	155.00
TOTAL:					\$155.00

PAYMENT INFORMATION			
NOTE: Items will appear on credit card statement as "Bureau of Land Mgmt CO".			
1	AMOUNT:	155.00	POSTMARKED: N/A
	TYPE:	CREDIT CARD	RECEIVED: 07/10/2014
	NAME:	WOTHERSPOON, DON 2310 SWIFT DR LAKE HAVASU CITY AZ 86404-2037 US	
	CARD NO:	XXXXXXXXXXXX1905	AUTH CODE: 309590
	NAME ON CARD:	DONALD L WOTHERSPOON	
	EXPIRES:	05/2015	
	SIGNATURE:		

REMARKS

This receipt was generated by the automated BLM Collections and Billing System and is a paper representation of a portion of the official electronic record contained therein.

MAINTENANCE FEE FORM

THIS IS THE FORM I SENT TO LA PAZ COUNTY RECORDER ,I THEN RECEIVED A CALL FROM CINDY AT THE RECORDERS OFFICE . SAYING THAT IN ORDER TO RECORD THIS FORM SHE NEEDED A SIGNATURE ,SO I DROVE FROM HAVASU TO PARKER TO SIGN FORM . WHEN I RECEIVED THIS FORM BACK I MARKED IT COPY AND FILED IT ?????? DON'T KNOW WHAT I WAS THINKING .SO I CALLED CINDY AND CHECKED WHEN SHE MAILED THIS FORM BACK TO ME , AUGUST 5TH. SO BACK TO MY FILES AND PULLED THIS OUT .

SO I HOPE YOU WILL ACCEPT THIS WITH A LITTLE WHITE OUT ON IT . .IF NOT PLEASE CALL ME AND I WILL RUN TO COUNTY RECORDER AND RECORD ANOTHER AND OVERNITE TO YOU ,OR I CAN RUN IT UP TO YOU .

IF THERE IS A PROBLEM PLEASE CALL ME AT 928-855-5549.

THANK YOU

DON WOTHERSPOON

RECEIVED
BLM AZ STATE OFFICE
2013 AUG 22 P 3:06
PHOENIX, ARIZONA

When Recorded Mail to:

Name: Don Wotherspoon

Address: 2310 Swift Dr

City: LHC State: AZ

Zip: 86044

Document Title

RECEIVED
BLM AZ STATE OFFICE
2013 AUG 22 P 3 06
PHOENIX, ARIZONA

NOTICE OF INTENTION TO HOLD MINING CLAIMS/SITES

When Recorded Return Document to:

Don Wotherspoon
2310 Swift Dr.
LAKE HAVASU CITY, AZ 86404

RECEIVED
BLM AZ STATE OFFICE
2013 AUG 22 P 3:05
PHOENIX, ARIZONA
BLM
Date
Stamp

Check here if this is a change of address.

Telephone: _____

E-mail Address _____

I (We) intend to hold the claims(s) and/or site(s) listed below for the calendar year 2014, and I (We) have filed or will file a Notice of Intent to Hold in the county where the claim (s) is located.

Reason for filing a Notice of Intent to Hold instead of an assessment work filing (check one):

- Maintenance fee was paid to maintain claim(s) during this assessment year.
- Mill or tunnel sites.
- Claim(s) was located during the current assessment year.
- BLM has deferred assessment work (attach copy of decision granting deferment, or pending petition for deferment including date petition was filed.)

Line No.	AMC NUMBER	CLAIM/SITE NAME	COUNTY RECORDER DATA (if available)	TWP	RNG	SEC
1	415645	Rios Oro 2	2012-02140	5N	11W	23
2						
3						
4						
5						
6						
7						
8						
9						
10						

NOTICE OF INTENTION TO HOLD MINING CLAIMS/SITES
page 2

BLM Date Stamp	RECEIVED BLM AZ STATE OFFICE 2013 AUG 22 P 3:05 PHOENIX, ARIZONA
----------------------	---

1. State of Arizona, County of Mohave
2. I (Name) Don Wotherspoon
3. Reside at (Address) 2310 Swift Dr
 City LAKE HAVASU CITY County Mohave State AZ zip 86404 being duly sworn, depose and say that I am a citizen of the United States, more than eighteen years of age, that all of the facts set forth in this notice, subject to the provisions and penalties of 18 U.S.C. 1001 pertaining to the filing of false, fictitious, or fraudulent statements with the United States, are true and correct according to the best of my knowledge, information and belief.
4. Owner's name and address (If not shown in Items 1-3 above) Marie Wotherspoon
2310 Swift Dr. Lake Havasu City, AZ. 86404
5. Dated: 7-23-2013 Signature: Don Wotherspoon

Bureau of Land Management
Arizona State Office
www.az.blm.gov

No. of Claims:	<u>1</u>	x \$10 =	<u>10</u>
Check No:	<u>1097</u>	Init.	<u>DMW</u>
Receipt No.:	<u>2862644</u>		
For BLM Use Only			

United States Department of the Interior

Bureau of Land Management

LANDS/RECREATION & PLANNING

ONE N CENTRAL AVE

PHOENIX, AZ 85004 -2203

Phone: 602-417-9200

Receipt

No:

2862644

Transaction #: 2948532	
Date of Transaction: 08/22/2013	
CUSTOMER:	
DON WOTHERSPOON 2310 SWIFT DR LAKE HAVASU CITY, AZ 86404-2037 US	

LINE #	QTY	DESCRIPTION	REMARKS	UNIT PRICE	TOTAL
1	1.00	LOCATABLE MINERALS / MINING CLAIMS-NOT NEW-UNADJUD, ONE AUTH NO. ONLY / MINING CLAIM MONEY RECEIVED CASES: AMC415645/\$150.00	MAINT 2014/1 NOI 2013/1	- n/a -	150.00
TOTAL:					\$150.00

PAYMENT INFORMATION					
1	AMOUNT:	140.00	POSTMARKED:	08/20/2013	
	TYPE:	CHECK	RECEIVED:	08/22/2013	
	CHECK NO:	1096			
	NAME:	WOTHERSPOON, DON 2310 SWIFT DR LAKE HAVASU CITY AZ 86404-2037 US			
2	AMOUNT:	10.00	POSTMARKED:	08/20/2013	
	TYPE:	CHECK	RECEIVED:	08/22/2013	
	CHECK NO:	1097			
	NAME:	WOTHERSPOON, DON 2310 SWIFT DR LAKE HAVASU CITY AZ 86404-2037 US			

REMARKS

This receipt was generated by the automated BLM Collections and Billing System and is a paper representation of a portion of the official electronic record contained therein.

AMC 415645

MAINTENANCE FEE PAYMENT

Claimant Name: DON & MARIE WOTHERSPON
Address: 2310 SWIFT DR
City: LAKE HAVASU CITY State: AZ Zip: 86404-2037
Telephone: 928-855-5549
E-mail address: DW.PASADENA@AOL.COM
Signature: Don Wotherpon

RECEIVED
BLM AZ STATE OFFICE
2012 AUG - 3 P 1:42
PHOENIX, ARIZONA
BLM
Date
Stamp

Check here if this is a change of address.

LINE NO.	AMC NUMBER	CLAIM/SITE NAME	COUNTY RECORDER DATA (If available)	TWP	RNG	SEC
1	415645	Rios Oro Z	2012-02146	5N	12W	23
2						
3						
4						
5						
6						
7						
8						
9						
10						

List additional claims on Form MCF114.

Bureau of Land Management
Arizona State Office
www.blm.gov/az/

No. of Claims: 1 x \$140 = 140
Check No: 734 Init. FWC
Receipt No.: 262 2087
For BLM Use Only

Form: MCF112
Revised July 2009

This form is available from the Arizona Department of Mines and Mineral Resources and may be reproduced.

ENTERED IN COMPUTER
RE 8-15-12

United States Department of the Interior

Bureau of Land Management

LANDS/RECREATION & PLANNING

ONE N CENTRAL AVE

PHOENIX, AZ 85004 -2203

Phone: 602-417-9200

Receipt

No:

2622087

Transaction #: 2702463	
Date of Transaction: 08/03/2012	
CUSTOMER:	
DON WOTHERSPOON 2310 SWIFT DR LAKE HAVASU CITY, AZ 86404-2037 US	

LINE #	QTY	DESCRIPTION	REMARKS	UNIT PRICE	TOTAL
1	1.00	LOCATABLE MINERALS / MINING CLAIMS-NOT NEW-UNADJUD, ONE AUTH NO. ONLY / MINING CLAIM MONEY RECEIVED CASES: AMC415645/\$140.00	MAINT 2013/1	- n/a -	140.00
TOTAL:					\$140.00

PAYMENT INFORMATION					
1	AMOUNT:	140.00	POSTMARKED:	07/31/2012	
	TYPE:	CHECK	RECEIVED:	08/03/2012	
	CHECK NO:	734			
	NAME:	WOTHERSPOON, DON 2310 SWIFT DR LAKE HAVASU CITY AZ 86404-2037 US			

REMARKS

This receipt was generated by the automated BLM Collections and Billing System and is a paper representation of a portion of the official electronic record contained therein.

NOTICE!!

These documents have been scanned!

Do not place un-scanned documents beneath this notice!

Do not remove this notice from this file!

GPO Jacket No. 560-102
Print Order 61540
Rise Business Services, LLC
Job=AZ15 5/14/2019



Box Number= AZ15047



Claim Begin-End: AMC415645-AMC415645

6 Location Notices-Amendments and Supporting Documents



AZ15047-5 AMC415557-AMC416189

MING CLAIM STATUS REPORT

DATA ENTERED MAY 16 2012 *pb*

MTP Checked by MAY 11 2012 *pb*
GEO Checked by MAY 11 2012 *pb*

LEAD SERIAL NUMBER AMC 415645 thru AMC _____

OF CLAIMS & TYPE

1 LODE
_____ PLACER
_____ ASSOCIATION PLACER
_____ MILL SITE
_____ TUNNEL SITE

CHARGES

Location Fee @ \$34 = \$ 34.00
Processing Fee @ \$15 = \$ 15.00
Maintenance Fee @ \$140 = \$ 140.00
Overage (+) \$ _____
Shortage (-) \$ _____
Other Fees \$ _____
TOTAL \$ 189.00

ARE THERE ENOUGH LOCATORS?

Yes No

DOCUMENTS RECEIVED VIA -

Over-the-Counter Mail

TIMELY FILED?

Yes No

LEGAL DESCRIPTION - T 5N R 11W SEC 023,024
T _____ R _____ SEC _____
T _____ R _____ SEC _____
T _____ R _____ SEC _____

BLM FOREST SERVICE SUBJ TO PL 359: Yes No

WILDERNESS AREA: No Yes

SPLIT ESTATE - N/A SX PX SRHA OTHER

Proper Notice Filed if Located on SHRA Lands? N/A Yes No

RECONVEYED MINERALS ON BLM LANDS REQUIRE OPENING ORDERS FROM 1944 TO 1993 -

Open to Entry on: _____ N/A

COMMENTS/STATUS - VOID PARTIALLY VOID PVT MINERALS WITHDRAWN LANDS

OTHER

Claimant acknowledges that portions of the following claims(s) site(s) may be void or voidable.

Printed Name of Claimant _____ Signature of Claimant _____

***** FINAL ADJUDICATION *****

DATE 6/25/2012 INITIALS TS

A110415645

When recorded please return to:

Don Wotherspoon
2310 Swift Dr.
Lake Havasu City
Az. 86404-2037

Location Notice for Lode Mining Claim

Notice is hereby given that the undersigned have on this 5th day of march, 2012 located a lode mining claim in La Paz County, State of Arizona.

The name of this claim is Rios Oro 2 and is situated in North East 40 acre corner of the South East ¼ section of Section 23 Township 5 N., Range 11 W. & the north west 40 acre corner of the South west ¼ section of section 24 Gila & Salt River Base and Meridian Arizona.

This is an 20.66 acre Lode claim with discovery of valuable minerals , Gold & Silver.

The locators of this claim are

Don Wotherspoon & Marie wotherspoon
2310 Swift Dr.
Lake Havasu City
AZ. 86404-2037

The locality of this claim with reference to some natural object or permanent monument and additional information concerning its locality are as follows:

Beginning at a 2x2 wood post & rock pile located at the location & center line then North 300' to the N/W corner . then East 1500' to the N/E corner ,then South 300' to the center line & then south again 300' to the S/E corner 'then west 1500' to the S/W corner ,& then 300' north to the beginning center line & location monument .

Dated and posted on the ground this 5th day of March, 2012.

Locator(s)

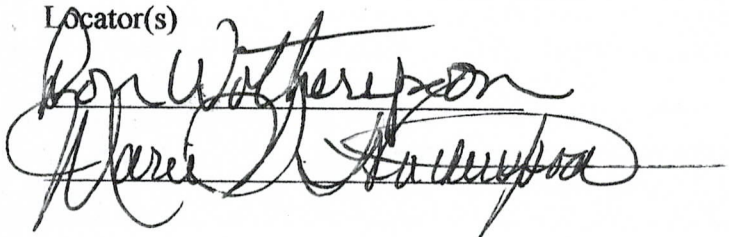

ARIZONA 15645

20.66A

RECEIVED
BLM ARIZONA OFFICE
2012 MAY -4 PM 2:46
TUCSON, ARIZONA

LAT. 33.758758
 LONG. 113.370268
 LOCATION →

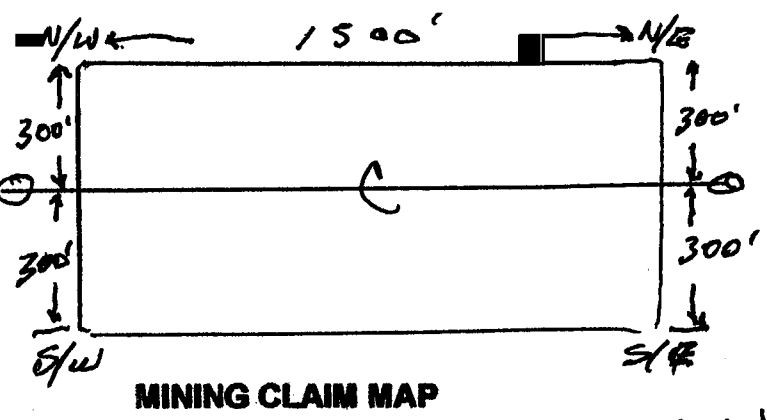

MINING CLAIM MAP

Lode Placer ()

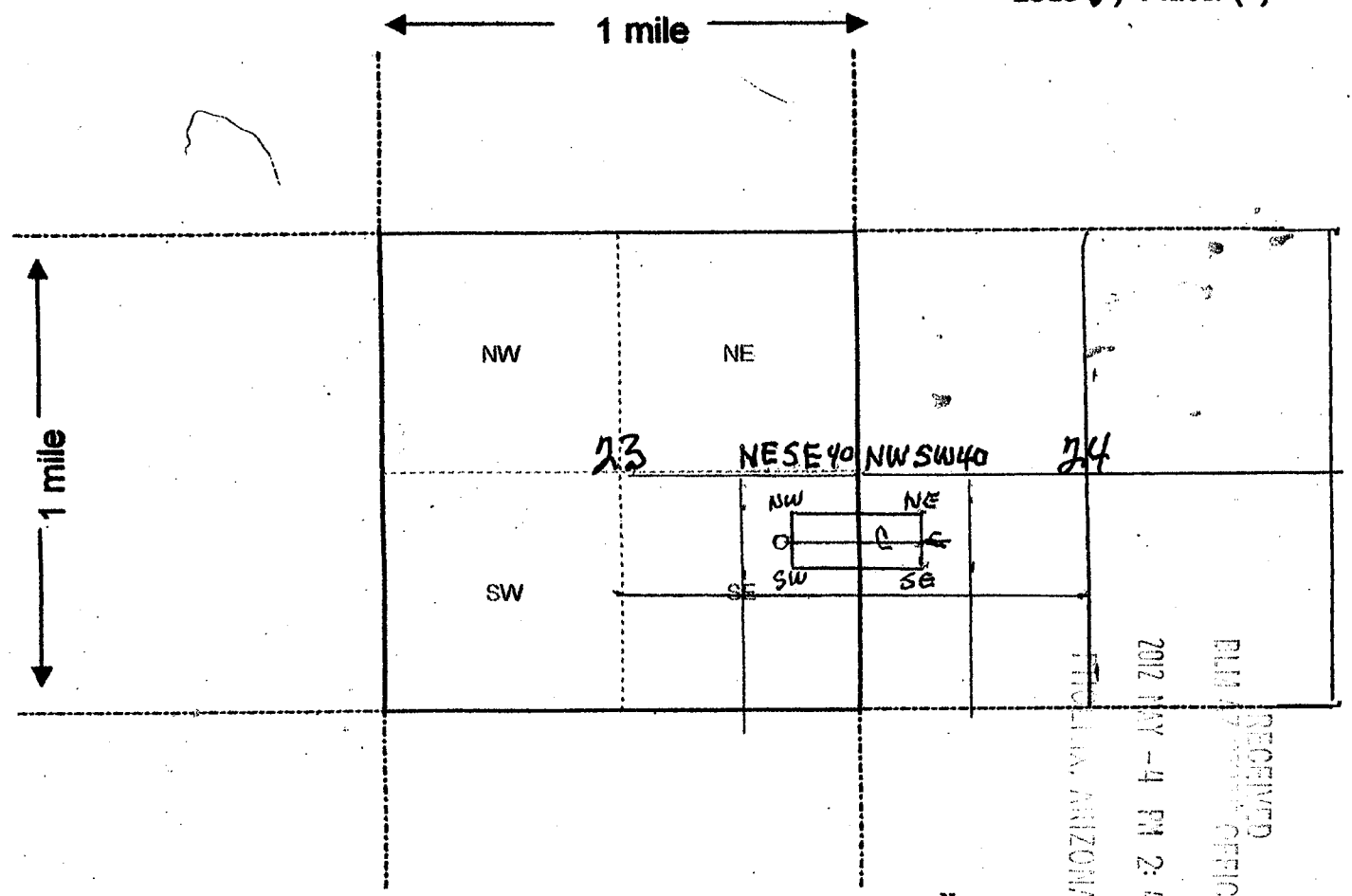

Scale : 1" = 2000 feet

RECEIVED
 BLM DISTRICT OFFICE
 2012 MAY -4 PM 2:46
 TUCUEN, ARIZONA

A10115645

- The above map depicts the RIOS ORO 2 mining claim, which is located in Section (s) 23-24, Township 5 N, Range 11 W, Gila and Salt River Base and Meridian, LA PAZ County, Arizona.
- The type of corner and location monuments used are as follows: 2" x 2" x 5' Wood Posts
Rock Pile With 2" x 2" x 5' Wood Post + LOCATION NOTICE
- The bearings and distances in degrees and feet between claim corners are as depicted on the map.

Form MCF100a
 Revised July 2005



Mr. Donald L. Wotherspoon
2310 Swift Dr.
Lk. Havasu Cty, AZ 86404

LAS VEGAS NV 890

01 MAY 2012 PM 2 L



RECEIVED
BLM AZ OFFICE
PHOENIX, ARIZONA
2012 MAY -4 PM 2:46

BLM arizona State office
One North Central Ave. Suite 800
Phoenix, Az 85004 - 4427

File Claim

85004\$2322





Mr. Donald L. Wotherspoon
2310 Swift Dr.
Lk. Havasu Cty, AZ 86404

LAS VEGAS NV 890

01 MAY 2012 PM 2 L

RECEIVED
BLM AZ
PHOENIX, ARIZONA
2012 MAY -4 PM 2:46

BLM arizona State office
One North Central Ave. Suite 800
Phoenix, Az 85004-4427

File Chair

85004\$2022

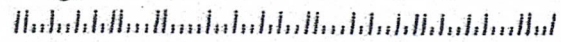

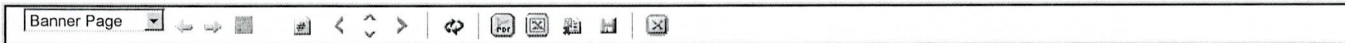

RUN TIME: 04:26 PM

RUN DATE: 05/11/2012
Page 1 of 1

DEPARTMENT OF INTERIOR
BUREAU OF LAND MANAGEMENT

Input Parameters for Geographic Report with Land

System Id = CR

Admin State = AZ

Geo State = AZ

Casetype Begins With

Case Disp Txt = AUTHORIZED, CANCELLED, EXPIRED, PENDING, REJECTED, RELINQUISHED, WITHDRAWN

Mer Twp Rng =

Section =

Mtrs = 14 0050N 0110W 023, 14 0050N 0110W 024, 14 0050N 0110W 999

Commodity =

Commodity Txt =

Pending Org =

Pend Org Decode =

Total Rows Returned: 0

NO WARRANTY IS MADE BY BLM FOR USE OF THE DATA
FOR PURPOSES NOT INTENDED BY BLM

